

DURASTEP Standard

The perfect solution.

DURAL

Anti-slip step nosing for ceramic tiles Width: 25 mm

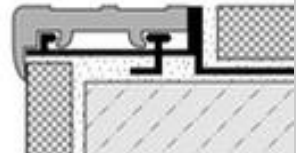
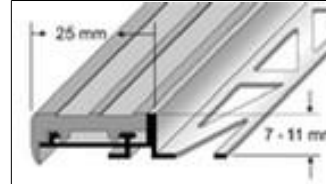

Application:

DURASTEP Standard profiles made by Dural are especially resistant staircase profiles for the domestic area. They are provided with a complete insert of PVC and have an anti-skid tread surface. This profile is available in five colours. The profiles are tightly imbedded into the lining, the tread surfaces however, can be replaced with the appearance of wear. DURASTEP does not only protect the front edge of the stairs but also visually enhances the staircase. The DURASTEP standard profiles are provided with a 5-year guarantee on the PVC-Top.

Material:

The following colours are available for the DURASTEP standard profiles of PVC: white, beige, black, brown and grey. The profiles consist of an aluminium carrier profile and a PVC lining. The invisible bottom part is made of hard plastic, the anti-skid surface of soft plastic. The width of the profile is of 25 mm.

Properties:

The DURASTEP standard profiles were developed for the application in areas which are of reduced use. This includes domestic areas and smaller size offices. The profiles are resistant against chemical stresses which generate during the laying of tiles. Damages by bending or scratching are improbable in case of normal use.

STONE CONCEPT HOLDINGS P/L

3/179-183 Woodpark Road, Smithfield, NSW, 2164

Tel. +61 (02) 9757 3880

Fax +61 (02) 9818 5073

products@stoneconcept.com.au

www.stoneconcept.com.au

07.04.2008

Handling:

1. Select the DURASTEP standard profile according to the thickness of tiles.
2. Place the lining material in the right height at the raiser.
3. Apply tile cement in the edge area using a toothed trowel.
4. Press the carrier profile completely into the cement bed and align the front edge flush with the tile of the raiser.
5. Completely cover the fastening legs.
6. Now, press the tiles tightly in and align them flush with the upper profile edge. Place tiles well embedded.
7. Leave a joint of 2 mm between tile and profile.
8. Completely fill the space between tiles and profile with joint mortar.

Care:

Durastep standard profiles do not need any special care. Dirt deposits can be removed with the usual commercial cleaning materials. The cleaning materials have to be free of hydrochloric acid and hydrofluoric acid and must not be abrasive.

Data sheet

Material	Insert Color	Height/ Width
Aluminium with PVC-Insert	white / beige / black / brown / grey	7 / 9 / 11 mm Height with 25 mm visible surface

STONE CONCEPT HOLDINGS P/L

3/179-183 Woodpark Road, Smithfield, NSW, 2164

Tel. +61 (02) 9757 3880

Fax +61 (02) 9818 5073

products@stoneconcept.com.au

www.stoneconcept.com.au